

# RESIDENTIAL COMPONENT OF CHAPEL HILL NORTH

SPECIAL USE PERMIT  
CHAPEL HILL, NORTH CAROLINA  
PROJECT NUMBER: CPR-03030

JUNE 1, 2004  
REVISED NOVEMBER 16, 2005  
REVISED APRIL 3, 2006  
REVISED MAY 18, 2006  
REVISED JUNE 2, 2006  
REVISED SEPTEMBER 27, 2006  
REVISED DECEMBER 7, 2006  
REVISED DECEMBER 20, 2006

SHEET INDEX  
1 COVER SHEET  
2 SURVEY  
3 AREA MAP  
4 SITE ANALYSIS  
5 SITE PLAN  
6 GRADING / DRAINAGE PLAN  
7 UTILITY PLAN  
8 LANDSCAPE / LANDSCAPE  
PROTECTION PLAN  
9 CHAPEL HILL NORTH REVISION  
SPECIAL USE PERMIT BOUNDARIES

OWNER:  
CROSLAND, INC.  
4000 WESTCHASE BLVD., SUITE 390  
RALEIGH, NC 27607

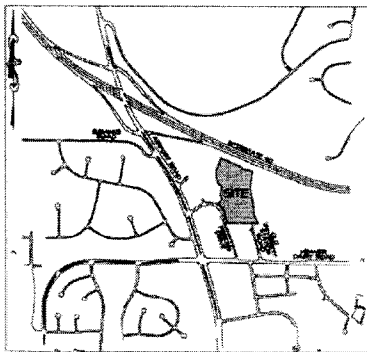

VICINITY MAP  
1" = 800'

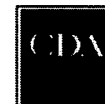

CLINE DESIGN  
ASSOCIATES, P.A.  
125 N. HARRINGTON STREET  
RALEIGH, NC 27603  
(919) 833-6413



THE JOHN R. McADAMS  
COMPANY, INC.

ENGINEERS/PLANNERS/SURVEYORS  
RESEARCH TRIANGLE PARK, NC  
P.O. BOX 14005 ZIP 27709-4005  
(919) 361-5000

ATTACHMENT 4

31

32

INTERIOR TO  
UNDRAINED SWALE

OLD UNIVERSITY STATION ROAD

PERMANENT  
UNDRAINED SWALE

LEGEND

- EXISTING WOOD PILE
- NEW PILE CAP
- ▲ LANDMARK POINT
- ▲ POINT MARK
- WATER MARK
- WATER MARK
- FIRE SCOUR MARK
- TELEPHONE MARK
- TELEPHONE MARK
- LIBERTY MARK
- PILE MARK
- CURE PILE
- SHOWN UNDESIRABLE
- TYP. PILE
- STORM DRAIN
- DRAINAGE PILE LINE
- UNDERGROUND ELECTRIC
- UNDERGROUND TELEPHONE
- WATER LINE
- WATER MAIN LINE
- GAS LINE
- FENCE LINE
- FLOW LINE
- SWAMP ALLEYS 1/2
- SWAMP ALLEYS 1/3
- SWAMP ALLEYS 2/3
- × MARK TO BE REMOVED
- UNDESIRABLE TREE STUMP



PERMANENT DRAWING - NOT REISSUED FOR MODIFICATION

RESIDENTIAL COMPONENT  
OF CHAPEL HILL NORTH

CROSLAND, INC. PROJECT CONSULTANTS

CROSLAND, INC.  
4400 WILSON ROAD, SUITE 100  
CHARLOTTE, NC 28212

THE JOHN R. MCGADAMS  
COMPANY, INC.  
ARCHITECTS/PLANNERS/ENGINEERS

100 WEST WILSON ROAD, SUITE 100  
CHARLOTTE, NC 28212  
704.375.1000

DATE: 02-03-2003  
SCALE: 1"=40'  
SHEET NO: 32  
PROJECT NO: 02-03-2003  
DRAWN BY: JRM  
CHECKED BY: JRM  
APPROVED BY: JRM

LINED      MASTER PLAN AREA  
 DASHED      PHASE 1 MAP AREA  
 DOTTED      PHASE 2 MAP AREA PROPOSED

33

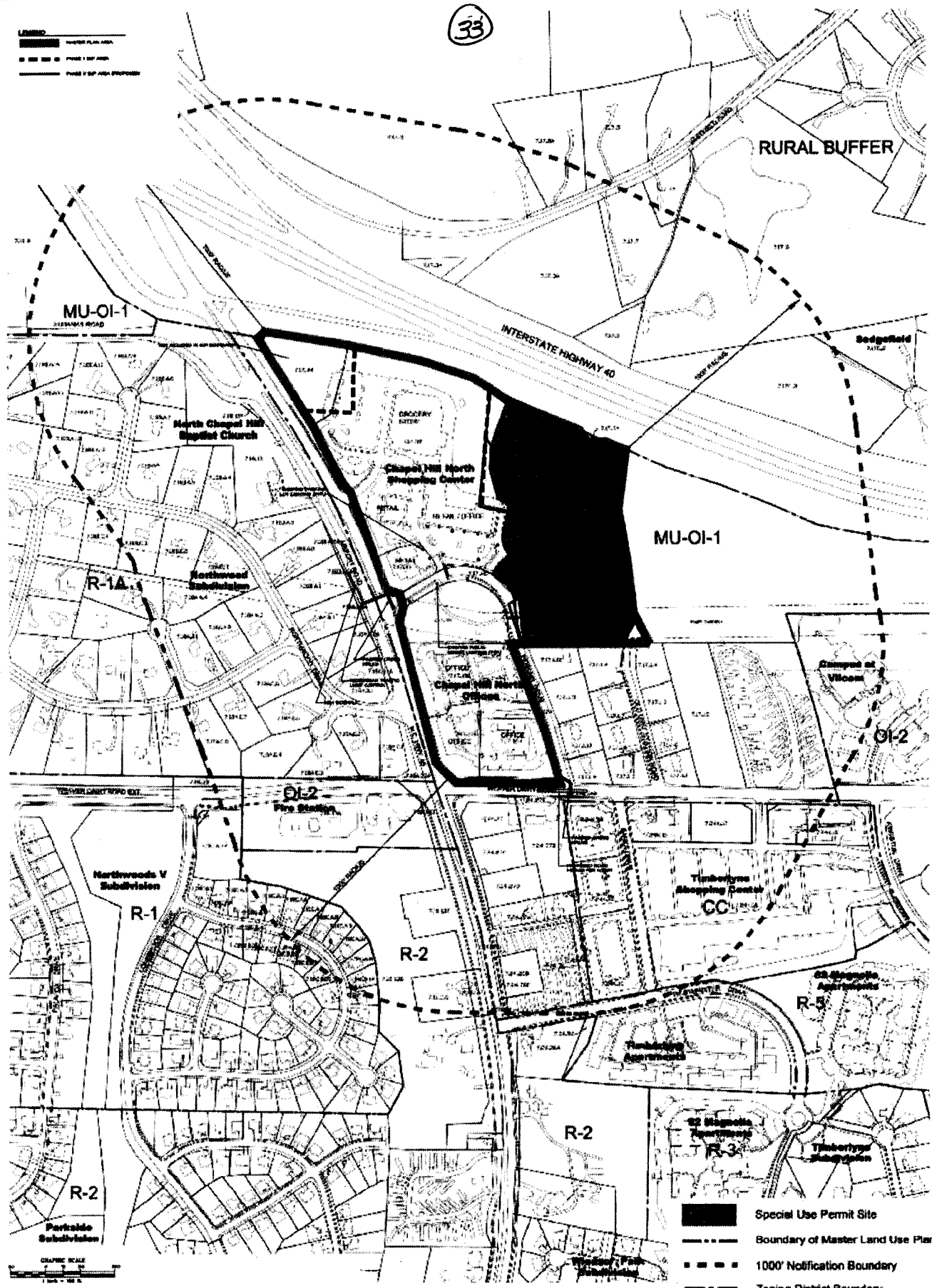

PRELIMINARY DRAWING AND RELEASED FOR CONSTRUCTION  
 INFORMATION USED TO CREATE THIS PLAN ORIGINALLY  
 COURTESY OF THE CROSLAND COMPANY, INC.

- Special Use Permit Site
- Boundary of Master Land Use Plan
- 1000' Notification Boundary
- Zoning District Boundary

DATE	DESCRIPTION
10/15/10	PRELIMINARY
11/15/10	REVISED
12/15/10	REVISED
01/15/11	REVISED
02/15/11	REVISED
03/15/11	REVISED
04/15/11	REVISED
05/15/11	REVISED
06/15/11	REVISED
07/15/11	REVISED
08/15/11	REVISED
09/15/11	REVISED
10/15/11	REVISED
11/15/11	REVISED
12/15/11	REVISED
01/15/12	REVISED
02/15/12	REVISED
03/15/12	REVISED
04/15/12	REVISED
05/15/12	REVISED
06/15/12	REVISED
07/15/12	REVISED
08/15/12	REVISED
09/15/12	REVISED
10/15/12	REVISED
11/15/12	REVISED
12/15/12	REVISED
01/15/13	REVISED
02/15/13	REVISED
03/15/13	REVISED
04/15/13	REVISED
05/15/13	REVISED
06/15/13	REVISED
07/15/13	REVISED
08/15/13	REVISED
09/15/13	REVISED
10/15/13	REVISED
11/15/13	REVISED
12/15/13	REVISED
01/15/14	REVISED
02/15/14	REVISED
03/15/14	REVISED
04/15/14	REVISED
05/15/14	REVISED
06/15/14	REVISED
07/15/14	REVISED
08/15/14	REVISED
09/15/14	REVISED
10/15/14	REVISED
11/15/14	REVISED
12/15/14	REVISED
01/15/15	REVISED
02/15/15	REVISED
03/15/15	REVISED
04/15/15	REVISED
05/15/15	REVISED
06/15/15	REVISED
07/15/15	REVISED
08/15/15	REVISED
09/15/15	REVISED
10/15/15	REVISED
11/15/15	REVISED
12/15/15	REVISED
01/15/16	REVISED
02/15/16	REVISED
03/15/16	REVISED
04/15/16	REVISED
05/15/16	REVISED
06/15/16	REVISED
07/15/16	REVISED
08/15/16	REVISED
09/15/16	REVISED
10/15/16	REVISED
11/15/16	REVISED
12/15/16	REVISED
01/15/17	REVISED
02/15/17	REVISED
03/15/17	REVISED
04/15/17	REVISED
05/15/17	REVISED
06/15/17	REVISED
07/15/17	REVISED
08/15/17	REVISED
09/15/17	REVISED
10/15/17	REVISED
11/15/17	REVISED
12/15/17	REVISED
01/15/18	REVISED
02/15/18	REVISED
03/15/18	REVISED
04/15/18	REVISED
05/15/18	REVISED
06/15/18	REVISED
07/15/18	REVISED
08/15/18	REVISED
09/15/18	REVISED
10/15/18	REVISED
11/15/18	REVISED
12/15/18	REVISED
01/15/19	REVISED
02/15/19	REVISED
03/15/19	REVISED
04/15/19	REVISED
05/15/19	REVISED
06/15/19	REVISED
07/15/19	REVISED
08/15/19	REVISED
09/15/19	REVISED
10/15/19	REVISED
11/15/19	REVISED
12/15/19	REVISED
01/15/20	REVISED
02/15/20	REVISED
03/15/20	REVISED
04/15/20	REVISED
05/15/20	REVISED
06/15/20	REVISED
07/15/20	REVISED
08/15/20	REVISED
09/15/20	REVISED
10/15/20	REVISED
11/15/20	REVISED
12/15/20	REVISED
01/15/21	REVISED
02/15/21	REVISED
03/15/21	REVISED
04/15/21	REVISED
05/15/21	REVISED
06/15/21	REVISED
07/15/21	REVISED
08/15/21	REVISED
09/15/21	REVISED
10/15/21	REVISED
11/15/21	REVISED
12/15/21	REVISED
01/15/22	REVISED
02/15/22	REVISED
03/15/22	REVISED
04/15/22	REVISED
05/15/22	REVISED
06/15/22	REVISED
07/15/22	REVISED
08/15/22	REVISED
09/15/22	REVISED
10/15/22	REVISED
11/15/22	REVISED
12/15/22	REVISED
01/15/23	REVISED
02/15/23	REVISED
03/15/23	REVISED
04/15/23	REVISED
05/15/23	REVISED
06/15/23	REVISED
07/15/23	REVISED
08/15/23	REVISED
09/15/23	REVISED
10/15/23	REVISED
11/15/23	REVISED
12/15/23	REVISED
01/15/24	REVISED
02/15/24	REVISED
03/15/24	REVISED
04/15/24	REVISED
05/15/24	REVISED
06/15/24	REVISED
07/15/24	REVISED
08/15/24	REVISED
09/15/24	REVISED
10/15/24	REVISED
11/15/24	REVISED
12/15/24	REVISED
01/15/25	REVISED

**RESIDENTIAL COMPONENT  
 OF CHAPEL HILL NORTH**  
 CHAPEL HILL, NORTH CAROLINA

**CROSLAND, INC.**  
 4000 WOODBRIDGE BLVD., SUITE 100  
 WASHINGTON, DC 20007

APPROVED:  
 [Signature]

**THE JOHN R. MOADAMS  
 COMPANY, INC.**  
 10000 WOODBRIDGE BLVD., SUITE 100  
 WASHINGTON, DC 20007  
 P.O. BOX 10000 WOODBRIDGE BLVD.  
 (202) 261-0000

AREA MAP

**LEGEND**

**SHADE PATTERNS**

- SOIL LUMP BOUNDARY
- FRONTIERS, STREAM
- SLOPE 1:1
- SLOPE 1:1.5
- SLOPE 1:2
- SLOPE 2:1
- SLOPE 3:1

**Soils Index**

- GeB - Claystone alluvium, 2-4% slope
- GeC - Claystone alluvium, 5-10% slope
- HrC - Hardpan alluvium, 5-10% slope

**Topography / Boundary**

Topographic contours are shown at 5-foot intervals. Contour lines are shown at 1-foot intervals. Boundaries and Tree Lines for 1975 Planning P.A. dated July 21, 1980.

**Additional Topographic Information**

Based on a contour map, the topographic information is shown on the map. The map shows the general location of the site and the surrounding area. The map also shows the location of the site and the surrounding area. The map also shows the location of the site and the surrounding area.

**Existing Vegetation**

Map of the site highlights areas of existing vegetation. The map shows the location of the site and the surrounding area. The map also shows the location of the site and the surrounding area. The map also shows the location of the site and the surrounding area.

**Stream Determination**

A stream determination was performed by the Town of Chapel Hill Engineering Department on September 20, 1982. The map shows the location of the site and the surrounding area. The map also shows the location of the site and the surrounding area. The map also shows the location of the site and the surrounding area.

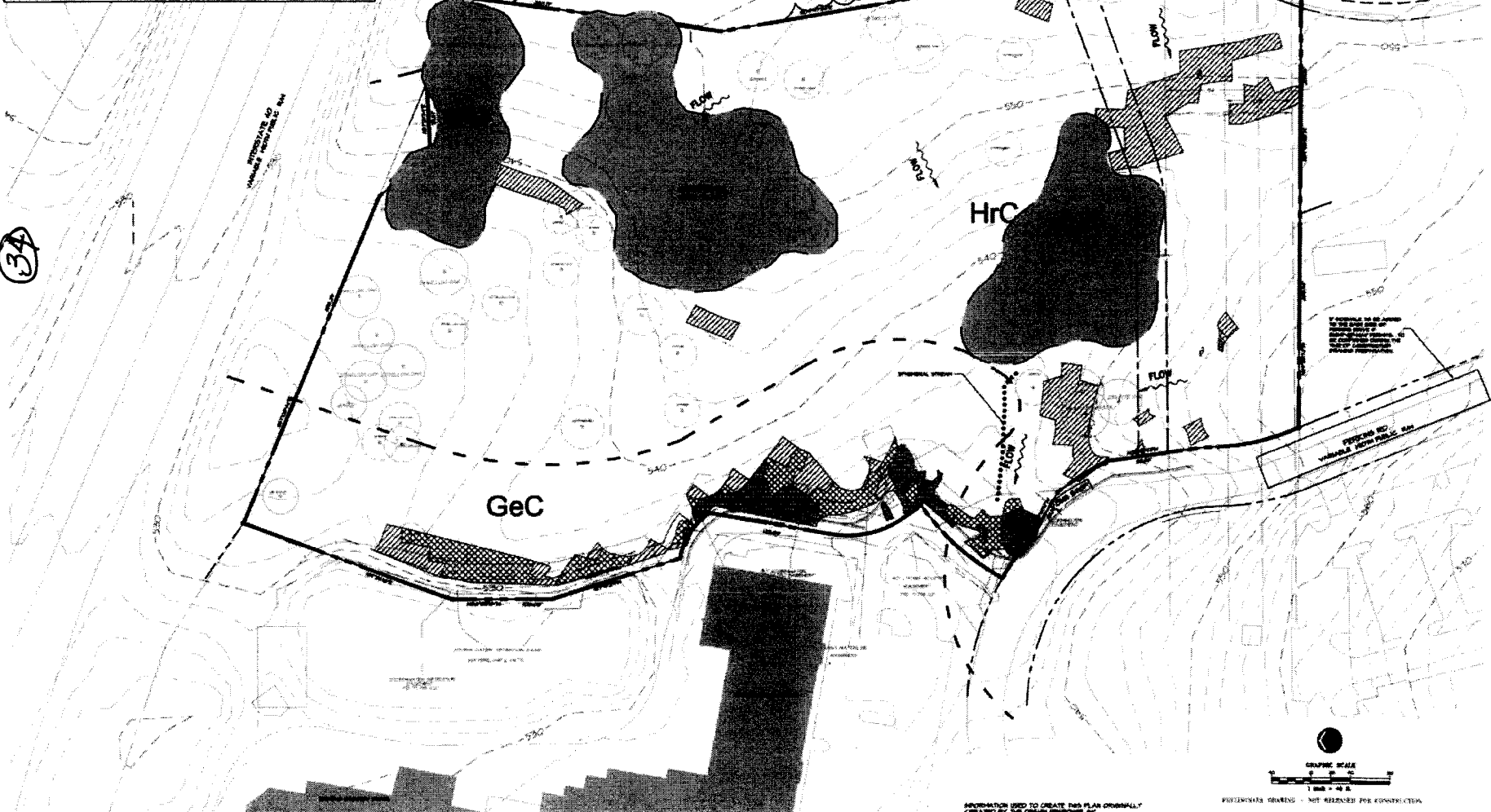

3A

**THE JOHN R. McADAMS COMPANY, INC.**  
 ENGINEERS/PLANNERS/ARCHITECTS  
 P.O. BOX 1000  
 CHAPEL HILL, N.C. 27514  
 (919) 941-0000

**CROSLAND, INC.**  
 400 UNIVERSITY PARK, SUITE 100  
 CHAPEL HILL, N.C. 27514

**RESIDENTIAL COMPONENT OF CHAPEL HILL NORTH**  
 CHAPEL HILL, NORTH CAROLINA  
 SITE ANALYSIS

DATE: 08-03-82  
 DRAWN BY: JRM  
 CHECKED BY: JRM  
 SCALE: 1" = 40'  
 SHEET NO: 04-03-002  
 OF 4

INFORMATION USED TO CREATE THIS PLAN ORIGINALLY CREATED BY THE DESAER RESPONSE, INC.  
 PHOTOGRAPHY DRAWING - NOT RELEASABLE FOR CONSTRUCTION











40

LEGEND  
THICK LINE - SPECIAL USE PERMIT BOUNDARY LINE  
DOTTED LINE - PROPERTY LINE

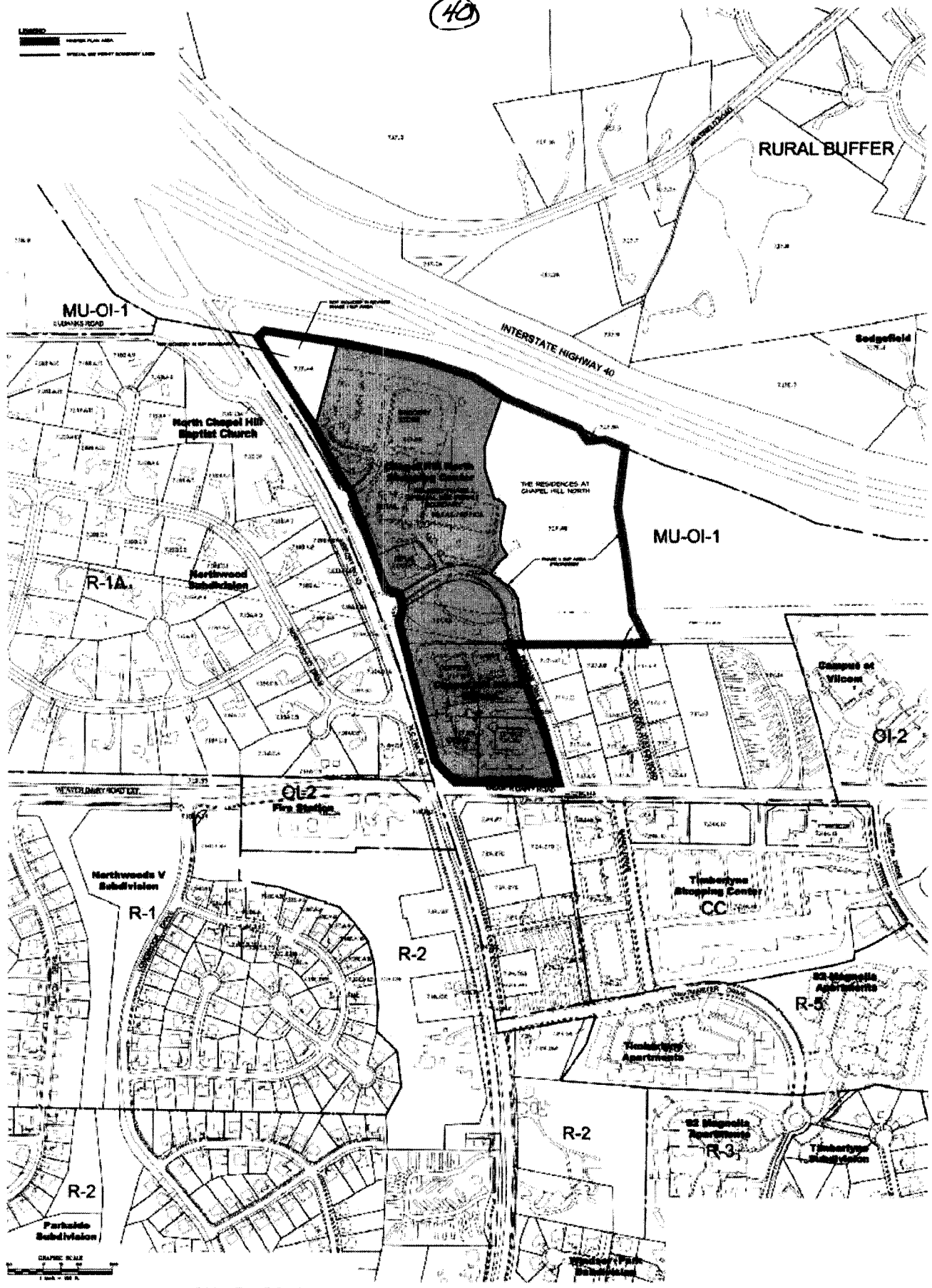

MU-OI-1  
SUDAN'S ROAD

RURAL BUFFER

INTERSTATE HIGHWAY 40

Sedgefield

North Chapel Hill Baptist Church

THE RESIDENCES AT CHAPEL HILL NORTH

MU-OI-1

R-1A

Northwood Subdivision

Compass at Vinton

OI-2

WENTLEBURY ROAD EXT.

OI-2  
Fire Station

Northwoods V Subdivision

R-1

R-2

Timberlynn Shopping Center  
CC

82 Magnolia Apartments

R-5

Timberlynn Apartments

R-2

82 Magnolia Apartments

Timberlynn Subdivision

R-2

Parhale Subdivision



PRELIMINARY EXHIBIT - NOT RELEASED FOR CONSTRUCTION

INFORMATION USED TO CREATE THIS PLAN ORIGINALLY  
CREATED BY THE CROSLAND SERVICE, INC.

REVISION	DATE	DESCRIPTION
1		
2		
3		
4		
5		
6		
7		
8		
9		
10		

### RESIDENTIAL COMPONENT OF CHAPEL HILL NORTH

CHAPEL HILL, SOLEDAD CALIFORNIA

CHAPEL HILL NORTH REVISED SPECIAL USE PERMIT BOUNDARIES

CROSLAND, INC.  
4400 WENTWORTH BLVD., SUITE 200  
DALLAS, TX 75247

APPROVED	DATE	DESCRIPTION

THE JOHN R. MCGADAMS COMPANY, INC.  
10000 WENTWORTH BLVD., SUITE 200  
DALLAS, TEXAS 75247  
(214) 261-9900