

Chapel Hill City Council:

The residences on Telluride Trail and San Sophia within the Silver Creek Subdivision respectfully requests the City to install "Maximum 2 hour parking 7am to 4pm Monday to Friday" signage (or similar restrictive type signage) on Telluride Trail, and on San Sophia.

Students from East Chapel Hill High School have been parking on said streets for the past few years. There are two stairways (Exhibit "A") on Telluride Trail that provides access from our subdivision directly onto the High School. The students have parking permits to park at the School but have decided that our residential streets are more convenient for their use. Unfortunately, what started as a few cars have now escalated to a nuisance amount of cars that have negatively impacted from the resident's own use and the appeal of our subdivision. There also have been safety issues due to the high speeds which the students exit our subdivision.

We are requesting to install "Max 2 hour parking" or similar type signage along both Telluride Trail and San Sophia. This restriction will limit student parking yet will still allow guests and workers of our homeowners to park.

Your prompt decision on this matter is appreciated, as we would like to have the signage installed before the start of school in August.

Please contact Ms. Christian Chan-Gilbert, who is our parking signage committee chair at (919) 360-0353 or at [xtian12@aol.com](mailto:xtian12@aol.com) if you have further questions.

Sincerely,

Parking Signage Committee representing  
Residences on Telluride Trail and San Sophia

# EXHIBIT "A"

## SILVER CREEK

CHAPEL HILL, NORTH CAROLINA

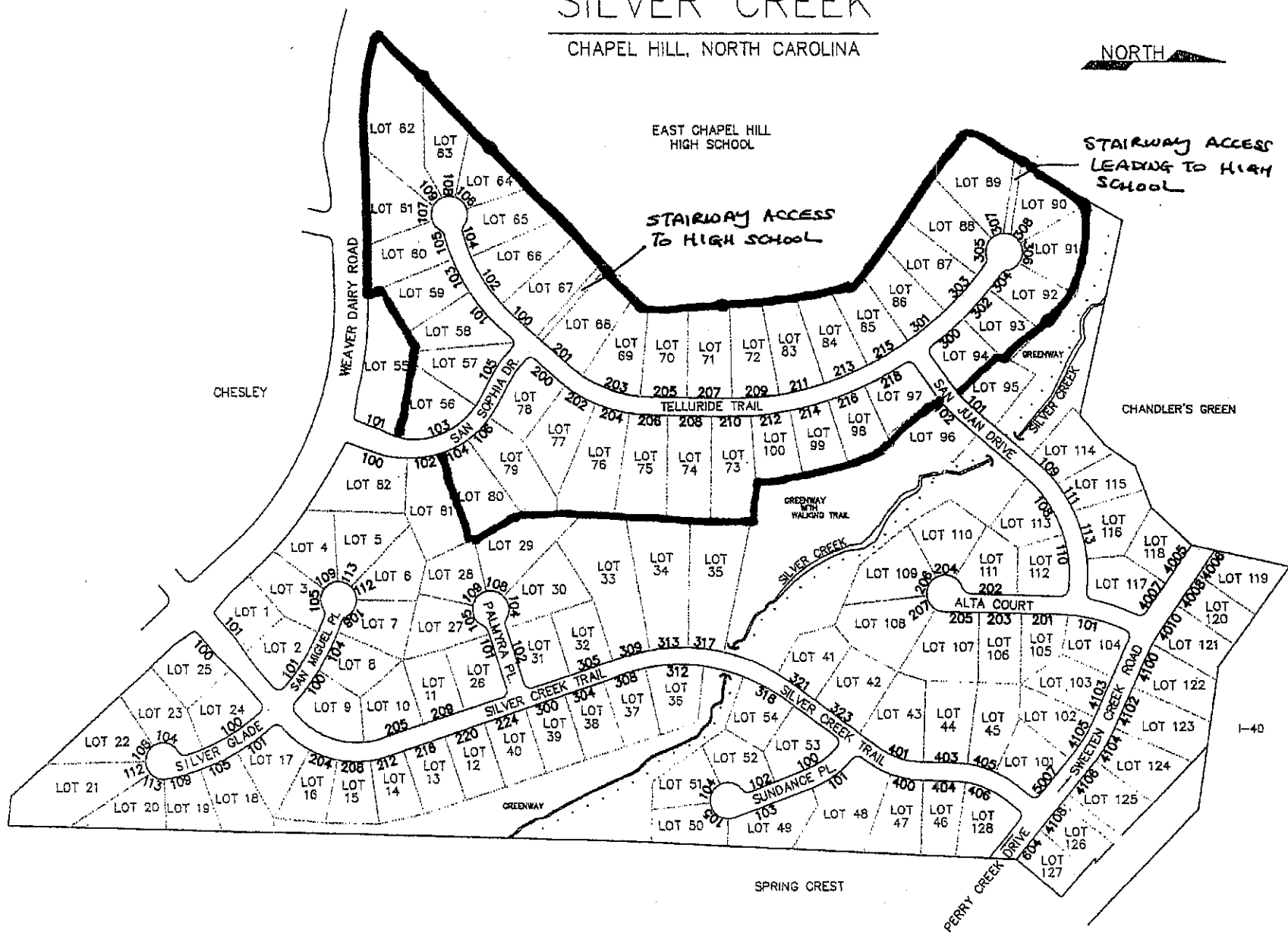

REVISED: 25 APR 05  
NO SCALE