

UNC PARK & RIDE LOT @ CHAPEL HILL BIBLE CHURCH

SPECIAL USE PERMIT
CHAPEL HILL, NORTH CAROLINA
PROJECT NUMBER: UNC-06000
DATE: JULY 6, 2006

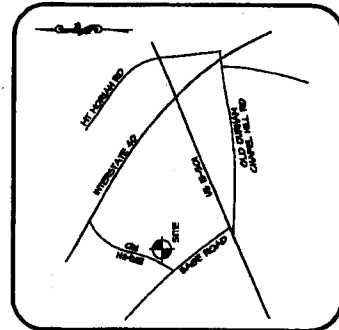

VICINITY MAP
NTS

APPLICANT:
UNC CHAPEL HILL,
GILES F. HORNEY BUILDING
CAMPUS HILL 1050
CHAPEL HILL, NORTH CAROLINA 27599
PHONE: (919) 943-7254

PN #: 9600516594
TIME: 7.26.18



THE JOHN R. McADAMS
COMPANY, INC.
ENGINEERS/PLANNERS/SURVEYORS
RESEARCH TRIANGLE PARK, NC
P.O. BOX 14005 ZIP 27709-4005
(919) 961-5000

SECRET NOTES
C-1
C-2
C-3
C-4
C-5
C-6
C-7
C-8
C-9
C-10
C-11
C-12
C-13
C-14
C-15
C-16
C-17
C-18
C-19
C-20
C-21
C-22
C-23
C-24
C-25
C-26
C-27
C-28
C-29
C-30
C-31
C-32
C-33
C-34
C-35
C-36
C-37
C-38
C-39
C-40
C-41
C-42
C-43
C-44
C-45
C-46
C-47
C-48
C-49
C-50
C-51
C-52
C-53
C-54
C-55
C-56
C-57
C-58
C-59
C-60
C-61
C-62
C-63
C-64
C-65
C-66
C-67
C-68
C-69
C-70
C-71
C-72
C-73
C-74
C-75
C-76
C-77
C-78
C-79
C-80
C-81
C-82
C-83
C-84
C-85
C-86
C-87
C-88
C-89
C-90
C-91
C-92
C-93
C-94
C-95
C-96
C-97
C-98
C-99
C-100

75

ATTACHMENT 2

THE JOHN R. McDAMMS COMPANY, INC.
MEMBER/OWNER/DEVELOPER
10000 W. WILSON ROAD
SUITE 100
DALLAS, TEXAS 75243
(214) 351-8888



DATE: 08/01/00
PROJECT: CHAPEL HILL BIBLE CHURCH
SHEET NO. 97

UNC CHAPEL HILL
CHURCH HILL BIBLE CHURCH
UNC CHAPEL HILL
CHURCH HILL BIBLE CHURCH

UNC PARK & RIDE LOT
CHAPEL HILL BIBLE CHURCH
UNC CHAPEL HILL
CHURCH HILL BIBLE CHURCH

| NO. | DESCRIPTION | NO. | DESCRIPTION |
|-----|--------------|-----|----------------|
| 1 | 1.00 AC. R-1 | 101 | 101.00 AC. R-1 |
| 2 | 1.00 AC. R-1 | 102 | 102.00 AC. R-1 |
| 3 | 1.00 AC. R-1 | 103 | 103.00 AC. R-1 |
| 4 | 1.00 AC. R-1 | 104 | 104.00 AC. R-1 |
| 5 | 1.00 AC. R-1 | 105 | 105.00 AC. R-1 |
| 6 | 1.00 AC. R-1 | 106 | 106.00 AC. R-1 |
| 7 | 1.00 AC. R-1 | 107 | 107.00 AC. R-1 |
| 8 | 1.00 AC. R-1 | 108 | 108.00 AC. R-1 |
| 9 | 1.00 AC. R-1 | 109 | 109.00 AC. R-1 |
| 10 | 1.00 AC. R-1 | 110 | 110.00 AC. R-1 |
| 11 | 1.00 AC. R-1 | 111 | 111.00 AC. R-1 |
| 12 | 1.00 AC. R-1 | 112 | 112.00 AC. R-1 |
| 13 | 1.00 AC. R-1 | 113 | 113.00 AC. R-1 |
| 14 | 1.00 AC. R-1 | 114 | 114.00 AC. R-1 |
| 15 | 1.00 AC. R-1 | 115 | 115.00 AC. R-1 |
| 16 | 1.00 AC. R-1 | 116 | 116.00 AC. R-1 |
| 17 | 1.00 AC. R-1 | 117 | 117.00 AC. R-1 |
| 18 | 1.00 AC. R-1 | 118 | 118.00 AC. R-1 |
| 19 | 1.00 AC. R-1 | 119 | 119.00 AC. R-1 |
| 20 | 1.00 AC. R-1 | 120 | 120.00 AC. R-1 |
| 21 | 1.00 AC. R-1 | 121 | 121.00 AC. R-1 |
| 22 | 1.00 AC. R-1 | 122 | 122.00 AC. R-1 |
| 23 | 1.00 AC. R-1 | 123 | 123.00 AC. R-1 |
| 24 | 1.00 AC. R-1 | 124 | 124.00 AC. R-1 |
| 25 | 1.00 AC. R-1 | 125 | 125.00 AC. R-1 |
| 26 | 1.00 AC. R-1 | 126 | 126.00 AC. R-1 |
| 27 | 1.00 AC. R-1 | 127 | 127.00 AC. R-1 |
| 28 | 1.00 AC. R-1 | 128 | 128.00 AC. R-1 |
| 29 | 1.00 AC. R-1 | 129 | 129.00 AC. R-1 |
| 30 | 1.00 AC. R-1 | 130 | 130.00 AC. R-1 |
| 31 | 1.00 AC. R-1 | 131 | 131.00 AC. R-1 |
| 32 | 1.00 AC. R-1 | 132 | 132.00 AC. R-1 |
| 33 | 1.00 AC. R-1 | 133 | 133.00 AC. R-1 |
| 34 | 1.00 AC. R-1 | 134 | 134.00 AC. R-1 |
| 35 | 1.00 AC. R-1 | 135 | 135.00 AC. R-1 |
| 36 | 1.00 AC. R-1 | 136 | 136.00 AC. R-1 |
| 37 | 1.00 AC. R-1 | 137 | 137.00 AC. R-1 |
| 38 | 1.00 AC. R-1 | 138 | 138.00 AC. R-1 |
| 39 | 1.00 AC. R-1 | 139 | 139.00 AC. R-1 |
| 40 | 1.00 AC. R-1 | 140 | 140.00 AC. R-1 |
| 41 | 1.00 AC. R-1 | 141 | 141.00 AC. R-1 |
| 42 | 1.00 AC. R-1 | 142 | 142.00 AC. R-1 |
| 43 | 1.00 AC. R-1 | 143 | 143.00 AC. R-1 |
| 44 | 1.00 AC. R-1 | 144 | 144.00 AC. R-1 |
| 45 | 1.00 AC. R-1 | 145 | 145.00 AC. R-1 |
| 46 | 1.00 AC. R-1 | 146 | 146.00 AC. R-1 |
| 47 | 1.00 AC. R-1 | 147 | 147.00 AC. R-1 |
| 48 | 1.00 AC. R-1 | 148 | 148.00 AC. R-1 |
| 49 | 1.00 AC. R-1 | 149 | 149.00 AC. R-1 |
| 50 | 1.00 AC. R-1 | 150 | 150.00 AC. R-1 |
| 51 | 1.00 AC. R-1 | 151 | 151.00 AC. R-1 |
| 52 | 1.00 AC. R-1 | 152 | 152.00 AC. R-1 |
| 53 | 1.00 AC. R-1 | 153 | 153.00 AC. R-1 |
| 54 | 1.00 AC. R-1 | 154 | 154.00 AC. R-1 |
| 55 | 1.00 AC. R-1 | 155 | 155.00 AC. R-1 |
| 56 | 1.00 AC. R-1 | 156 | 156.00 AC. R-1 |
| 57 | 1.00 AC. R-1 | 157 | 157.00 AC. R-1 |
| 58 | 1.00 AC. R-1 | 158 | 158.00 AC. R-1 |
| 59 | 1.00 AC. R-1 | 159 | 159.00 AC. R-1 |
| 60 | 1.00 AC. R-1 | 160 | 160.00 AC. R-1 |
| 61 | 1.00 AC. R-1 | 161 | 161.00 AC. R-1 |
| 62 | 1.00 AC. R-1 | 162 | 162.00 AC. R-1 |
| 63 | 1.00 AC. R-1 | 163 | 163.00 AC. R-1 |
| 64 | 1.00 AC. R-1 | 164 | 164.00 AC. R-1 |
| 65 | 1.00 AC. R-1 | 165 | 165.00 AC. R-1 |
| 66 | 1.00 AC. R-1 | 166 | 166.00 AC. R-1 |
| 67 | 1.00 AC. R-1 | 167 | 167.00 AC. R-1 |
| 68 | 1.00 AC. R-1 | 168 | 168.00 AC. R-1 |
| 69 | 1.00 AC. R-1 | 169 | 169.00 AC. R-1 |
| 70 | 1.00 AC. R-1 | 170 | 170.00 AC. R-1 |
| 71 | 1.00 AC. R-1 | 171 | 171.00 AC. R-1 |
| 72 | 1.00 AC. R-1 | 172 | 172.00 AC. R-1 |
| 73 | 1.00 AC. R-1 | 173 | 173.00 AC. R-1 |
| 74 | 1.00 AC. R-1 | 174 | 174.00 AC. R-1 |
| 75 | 1.00 AC. R-1 | 175 | 175.00 AC. R-1 |
| 76 | 1.00 AC. R-1 | 176 | 176.00 AC. R-1 |
| 77 | 1.00 AC. R-1 | 177 | 177.00 AC. R-1 |
| 78 | 1.00 AC. R-1 | 178 | 178.00 AC. R-1 |
| 79 | 1.00 AC. R-1 | 179 | 179.00 AC. R-1 |
| 80 | 1.00 AC. R-1 | 180 | 180.00 AC. R-1 |
| 81 | 1.00 AC. R-1 | 181 | 181.00 AC. R-1 |
| 82 | 1.00 AC. R-1 | 182 | 182.00 AC. R-1 |
| 83 | 1.00 AC. R-1 | 183 | 183.00 AC. R-1 |
| 84 | 1.00 AC. R-1 | 184 | 184.00 AC. R-1 |
| 85 | 1.00 AC. R-1 | 185 | 185.00 AC. R-1 |
| 86 | 1.00 AC. R-1 | 186 | 186.00 AC. R-1 |
| 87 | 1.00 AC. R-1 | 187 | 187.00 AC. R-1 |
| 88 | 1.00 AC. R-1 | 188 | 188.00 AC. R-1 |
| 89 | 1.00 AC. R-1 | 189 | 189.00 AC. R-1 |
| 90 | 1.00 AC. R-1 | 190 | 190.00 AC. R-1 |
| 91 | 1.00 AC. R-1 | 191 | 191.00 AC. R-1 |
| 92 | 1.00 AC. R-1 | 192 | 192.00 AC. R-1 |
| 93 | 1.00 AC. R-1 | 193 | 193.00 AC. R-1 |
| 94 | 1.00 AC. R-1 | 194 | 194.00 AC. R-1 |
| 95 | 1.00 AC. R-1 | 195 | 195.00 AC. R-1 |
| 96 | 1.00 AC. R-1 | 196 | 196.00 AC. R-1 |
| 97 | 1.00 AC. R-1 | 197 | 197.00 AC. R-1 |
| 98 | 1.00 AC. R-1 | 198 | 198.00 AC. R-1 |
| 99 | 1.00 AC. R-1 | 199 | 199.00 AC. R-1 |
| 100 | 1.00 AC. R-1 | 200 | 200.00 AC. R-1 |

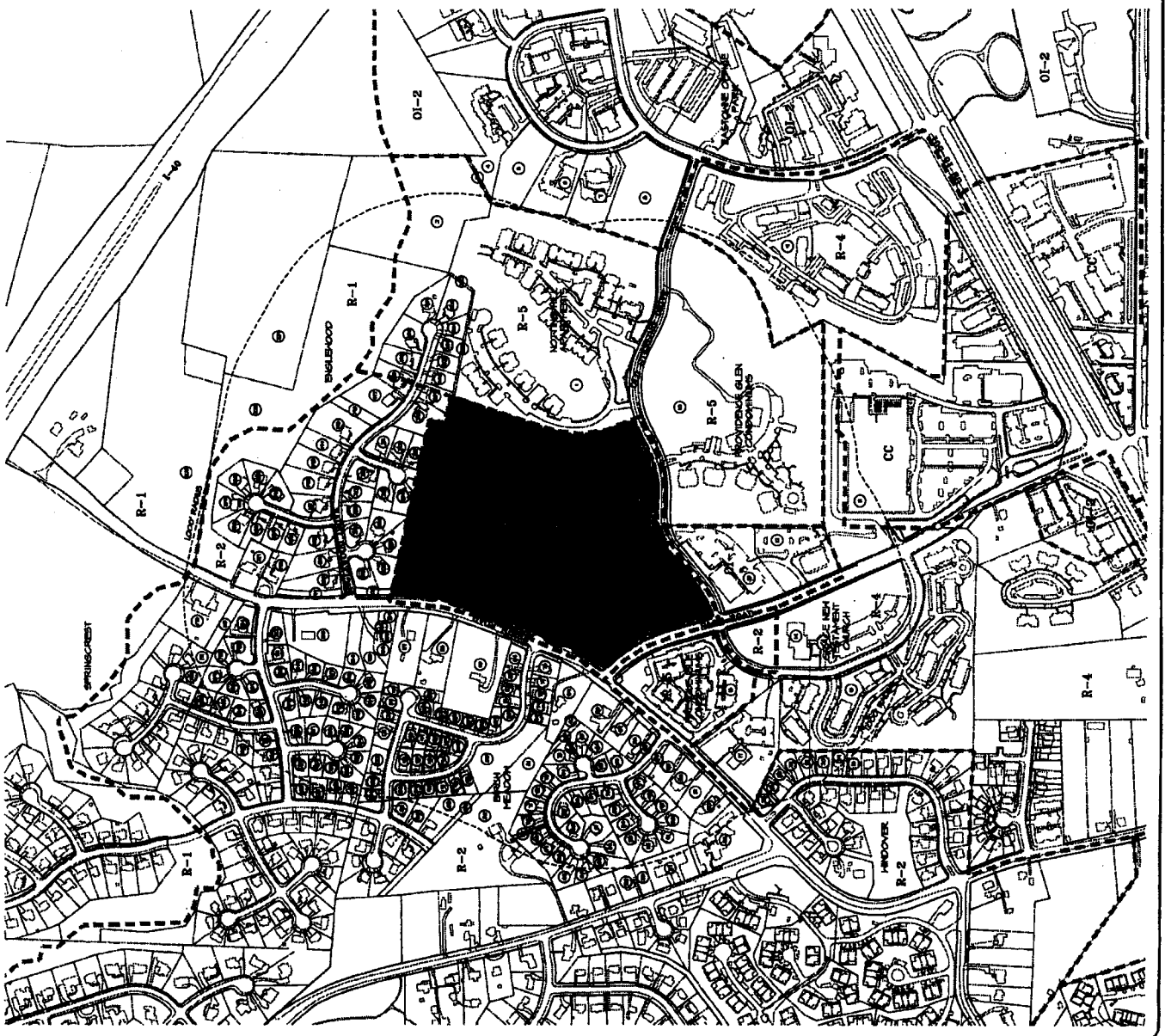

11

| | |
|--------------|----------|
| DATE | 11/11/06 |
| BY | ... |
| CHECKED | ... |
| SCALE | AS SHOWN |
| SHEET NO. | 11 |
| TOTAL SHEETS | 12 |

UNC PARK & RIDE LOT
CHapel Hill, Bible Church

UNC CHAPEL HILL
 BIBLE CHURCH
 1000 S. HAYWOOD DRIVE
 CHAPEL HILL, NC 27514

THE JOHN R. McDAMAS COMPANY, INC.
 1000 S. HAYWOOD DRIVE
 CHAPEL HILL, NC 27514
 (704) 943-1111

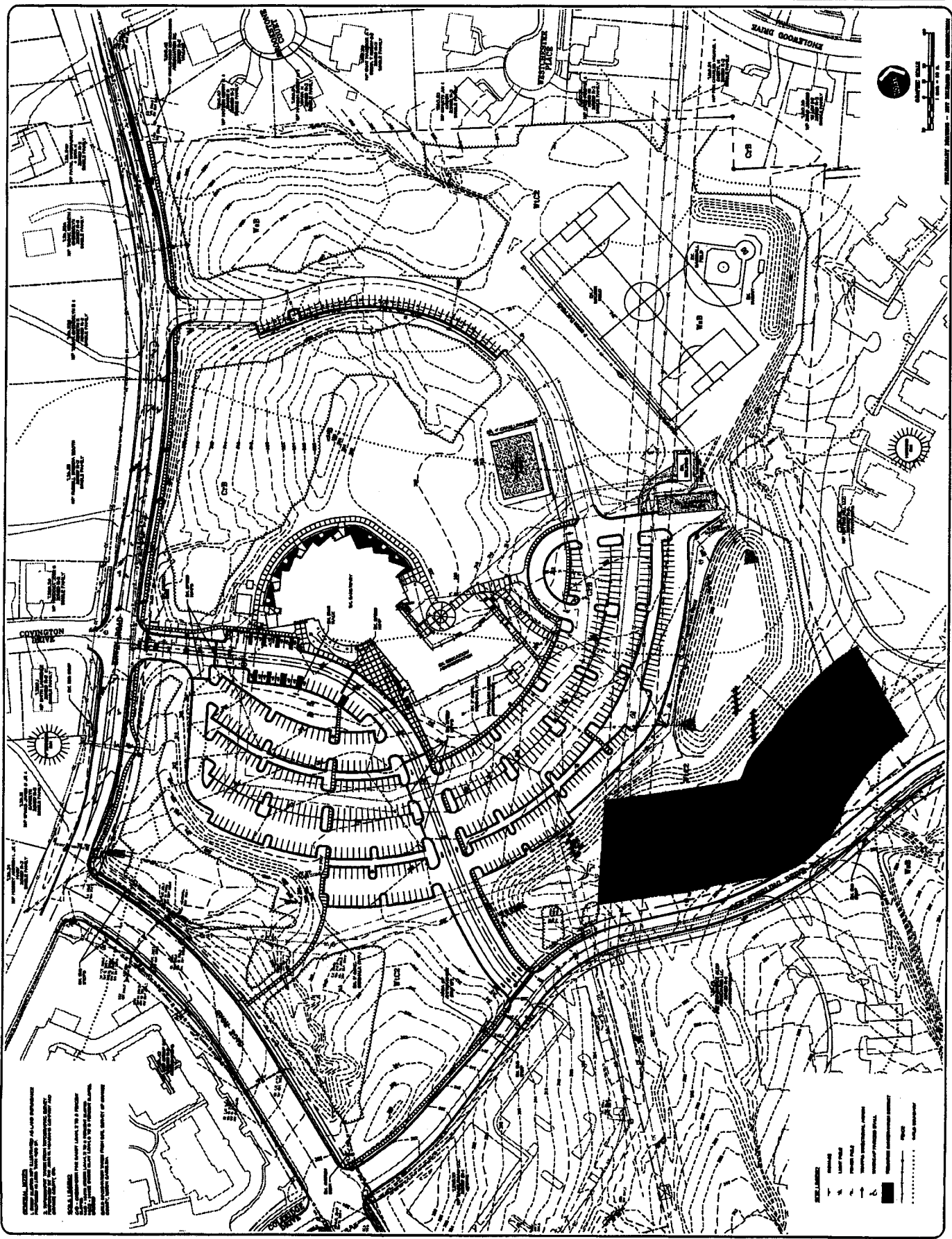

GENERAL NOTES:
 1. ALL CONSTRUCTION SHALL BE IN ACCORDANCE WITH THE LATEST EDITIONS OF THE INTERNATIONAL BUILDING CODES AND THE LATEST EDITIONS OF THE INTERNATIONAL PLUMBING AND MECHANICAL CODES.
 2. ALL UTILITIES SHALL BE DEPTH MARKED AND SHOWN ON THE PLAN.
 3. ALL EXISTING UTILITIES SHALL BE PROTECTED AND MAINTAINED THROUGHOUT THE CONSTRUCTION PERIOD.
 4. ALL EXISTING UTILITIES SHALL BE REPAIRED OR REPLACED AS NECESSARY.
 5. ALL EXISTING UTILITIES SHALL BE RELOCATED AS NECESSARY.
 6. ALL EXISTING UTILITIES SHALL BE DELETED AS NECESSARY.
 7. ALL EXISTING UTILITIES SHALL BE ABANDONED AS NECESSARY.
 8. ALL EXISTING UTILITIES SHALL BE PRESERVED AS NECESSARY.
 9. ALL EXISTING UTILITIES SHALL BE PROTECTED AND MAINTAINED THROUGHOUT THE CONSTRUCTION PERIOD.
 10. ALL EXISTING UTILITIES SHALL BE REPAIRED OR REPLACED AS NECESSARY.
 11. ALL EXISTING UTILITIES SHALL BE RELOCATED AS NECESSARY.
 12. ALL EXISTING UTILITIES SHALL BE DELETED AS NECESSARY.
 13. ALL EXISTING UTILITIES SHALL BE ABANDONED AS NECESSARY.
 14. ALL EXISTING UTILITIES SHALL BE PRESERVED AS NECESSARY.
 15. ALL EXISTING UTILITIES SHALL BE PROTECTED AND MAINTAINED THROUGHOUT THE CONSTRUCTION PERIOD.
 16. ALL EXISTING UTILITIES SHALL BE REPAIRED OR REPLACED AS NECESSARY.
 17. ALL EXISTING UTILITIES SHALL BE RELOCATED AS NECESSARY.
 18. ALL EXISTING UTILITIES SHALL BE DELETED AS NECESSARY.
 19. ALL EXISTING UTILITIES SHALL BE ABANDONED AS NECESSARY.
 20. ALL EXISTING UTILITIES SHALL BE PRESERVED AS NECESSARY.

THE JOHN R. MADDAMS COMPANY, INC.
 10000 W. 10TH AVENUE, SUITE 100
 DENVER, COLORADO 80231
 (303) 751-0000

UNC CHAPEL HILL
 1000 W. HARRIS DRIVE, SUITE 100
 CHAPEL HILL, NORTH CAROLINA 27514
 (919) 977-1000

UNC PARK & RIDE LOT 2
CHAPEL HILL BIBLE CHURCH
 SITE PLAN

DATE: 7/6/2006
 DRAWN BY: JRM
 CHECKED BY: JRM
 SCALE: AS SHOWN

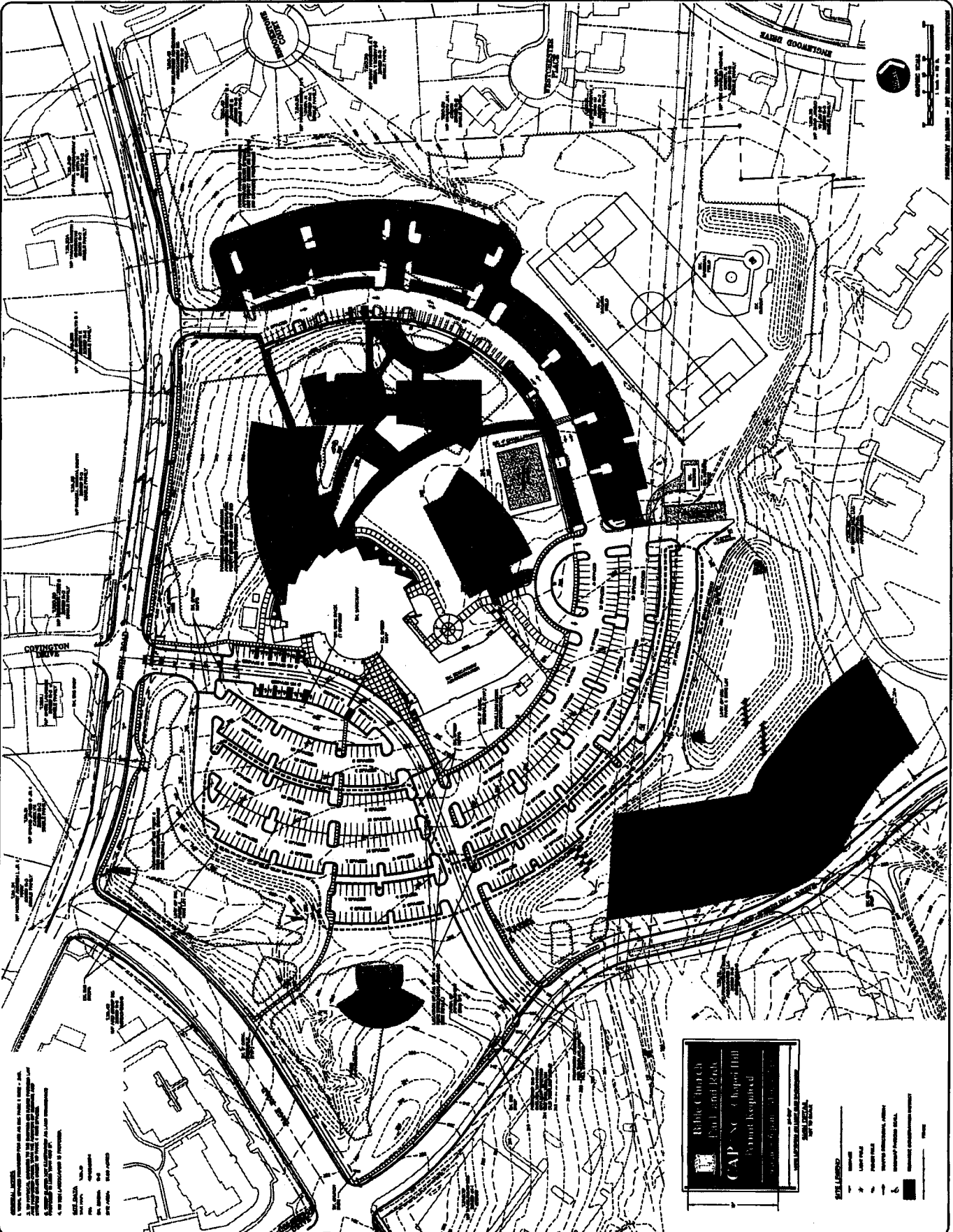

Chapel Hill Bible Church
 Chapel Hill, NC 27514
 919-977-1000
 www.chapelhillbiblechurch.org

- LEGEND**
- Proposed Building Footprint
 - Proposed Parking
 - Proposed Driveway
 - Proposed Easement
 - Proposed Utility
 - Proposed Fencing
 - Proposed Landscaping
 - Proposed Retention Wall
 - Proposed Stormwater Management
 - Proposed Access
 - Proposed Signage
 - Proposed Lighting
 - Proposed Security
 - Proposed Other