





www.pelcoinc.com
 320 W. 18TH ST, EDMOND OK 73013
 PH: 405-340-3434 FAX: 405-340-3435

This drawing is for reference only. It is the property of Pelco and is not to be used in whole or in part without Pelco's permission.

ASSEMBLY SHEET

REF:

TITLE: **ORNAMENTAL SERRATED
 ARTICULATING BANNER BRAC
 W/ASTRO MINI-BRAC**

PELCO NO.: **SH-3525**

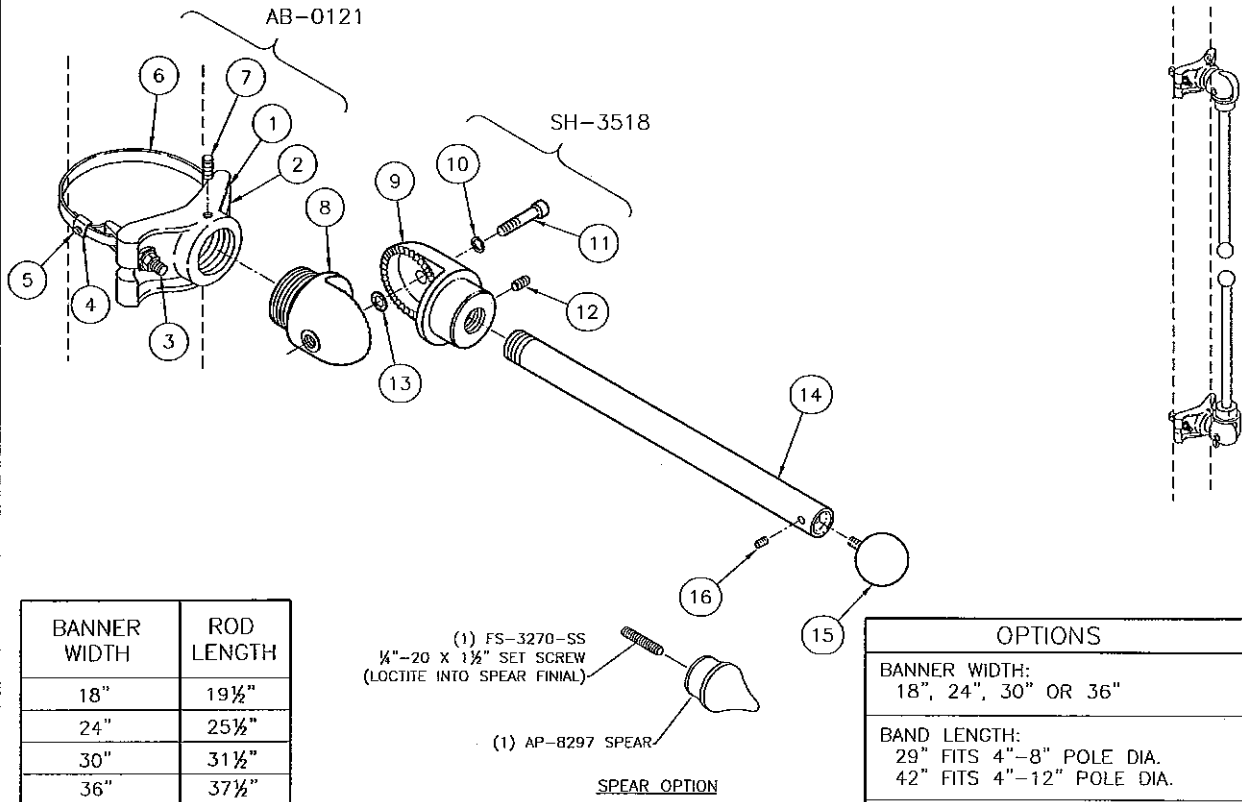

BANNER WIDTH	ROD LENGTH
18"	19 1/2"
24"	25 1/2"
30"	31 1/2"
36"	37 1/2"

(1) FS-3270-SS
 1/4"-20 X 1 1/2" SET SCREW
 (LOCTITE INTO SPEAR FINIAL)

(1) AP-8297 SPEAR

SPEAR OPTION

OPTIONS
BANNER WIDTH: 18", 24", 30" OR 36"
BAND LENGTH: 29" FITS 4"-8" POLE DIA. 42" FITS 4"-12" POLE DIA.
FINIAL: 2" BALL (SAME COLOR AS ASSY OR GOLD) 1-1/2" SPEAR (SAME COLOR AS ASSY OR GOLD)
PAINT

- NOTES:
- PLEASE SPECIFY BANNER WIDTH.
 - (2) BRACKET ASSY'S REQUIRED TO MOUNT BANNER.
 - PACKAGE BAND AND HARDWARE SEPARATELY

ITEM	PART NO.	DESCRIPTION	QTY
1	AB-0266-M1	CLAMP, MINI-BRAC, BAND MNT, 1 1/2"-11 1/2" NPS, ALUM	1
2	FS-6201-ZN1	PIN, GROOVE, 3/16" X 1-1/4", TYPE E, ZINC 1	1
3	AB-0303-SS	MINI-BRAC CLAMP SCREW KIT, 7/16", STAINLESS HDWR	1
4	AB-0244-SS	CLAMP, BAND, 5/8", STAINLESS	1
5	FS-3202-SS	SCREW, SET SOC HD, 5/16"-18 X 1/4", STAINLESS	1
6	AB-0243-L	BAND, 5/8" X 0.050" X LENGTH, TYPE 201, STAINLESS	1
7	FS-3217-SS	SCREW, SET SOC HD, 1/4"-20 X 3/8", STAINLESS	1
8	SH-2024-M6	ARTICULATING ELBOW, SERRATED, ALUM, 1-1/2"-11-1/2" NPS EXT.	1
9	SH-2024-M3	ARTICULATING ELBOW, SERRATED, 1"-8NC INTERNAL THREAD	1
10	FS-4227-SS	WASHER, HIGH COLLAR SPLIT LOCK, 3/8", STAINLESS	1
11	FS-2147-SS	SCREW, SOC HD CAP, 3/8"-16 X 2", STAINLESS	1
12	FS-3228-SS	SCREW, SET SOC HD, 5/16"-18 X 1/2", STAINLESS	1
13	FS-9095-ZN1	NUT, PUSH, 3/8", ZINC 1	1
14	AP-8264-L	ROD, 1" ALUM, THREADED 1"-8NC ONE END X LENGTH	1
15	AP-8208-M1	BALL, 2" DIA., W/1/4"-20 SETSCREW	1
16	FS-3217-SS	SCREW, SET SOC HD, 1/4"-20 X 3/8", STAINLESS	1

C:\Vault-Local\CAD\Pelco Dwg\sh\SH-3525.dwg, 9/7/2007 8:43:46 AM, Controlled Document Valid for 72 hours