



TOWN OF CHAPEL HILL

February 4, 2003

Scott Radway
Radway & Weaver
505 Westminster Drive
Chapel Hill, NC 27514

Dear Mr. Radway:

A site inspection of the property Tax Map # 7.27.A.3, Address: 101 Erwin Road, PIN# 9799-48- 0252 was conducted on February 3, 2003 and have found that the drainageway in question does not meet the minimum criteria as an intermittent stream.

It is an area where the water table and the ground elevation are equal. There is also a perennial water body on the adjacent parcel.

Regards,

Fred Royal, EI, CFM
Stormwater Management Engineer

FR/jcf

cc: Larry Tucker, Senior Engineering Coordinator
Deborah Squires, Senior G.I.S. Technician
Maggie Bowers, Zoning Enforcement Officer

REQUEST FOR REVIEW
OF A PERENNIAL STREAM (43)

DATE: JANUARY 29, 2003
NAME: SCOTT RADWAY
ADDRESS: 505 WESTMINSTER DRIVE
NAME OF FIRM: RADWAY & WEAVER
PHONE NO. 919.880.5579
LOCATION: Northwest Corner of Erwin Rd. Dobbins Dr. Intersection
TAX MAP: 27 BLOCK: A LOT: 3 TOPO: Attached.
PIN No.: 9799-4B-0252

MAPS REQUIRED TO MAKE DETERMINATION

3 acres or less - Plat or Tax Map
3 acres or more - Plat and Topo

ENGINEERING DEPARTMENT USE

DATE OF INSPECTION(S): 2/3/03
WEATHER: P/C TEMPERATURE: 65°F
INSPECTED BY: FRED ROYAL

COMMENTS

AREA IN QUESTION IS A NATURALLY DRAINAGEWAY
WITH A MAN-MADE POND & DAM. BELOW THE
DAM IS A DRAINAGEWAY AT OR BELOW THE
GROUNDWATER ELEVATION. POND IS LIKELY A PERENNIAL WATER BOX.
I OBSERVED NO INDICATIONS THAT THIS
DRAINAGEWAY MEETS THE PRIMARY OR SECONDARY
INDICATORS AS AN INTERMITTENT STREAM. (CRITERIA)
THEREFORE, THE RCD DOES NOT APPLY TO THIS
DRAINAGEWAY. SCORED A 9 ON CLASSIFICATION FORM.

44

TOWN OF CHAPEL HILL

306 NORTH COLUMBIA STREET
CHAPEL HILL, NORTH CAROLINA 27516

Telephone (919) 968-2700

RESOURCE CONSERVATION DISTRICT PROCEDURES FOR DETERMINATION

In 1986 along with the development of the Resource Conservation District Ordinance, the Engineering Department established a procedure for citizen requests for perennial stream determinations.

This was to establish a file of those properties that did have streams within their boundaries or which might be affected by the foot print of an adjacent stream.

These requirements are necessary for a full determination:

1. A cover letter requesting the determination.
2. The property's Tax Map and PIN Number.
3. If the property is 3 acres or less the plat or a tax map.
4. If property is 3 acres or more the plat and topographic map.

Attached is the Engineering Department form which may act as a cover letter if completed and the required map(s) are attached.

09/11/95

(45)
NCDWQ Stream Classification Form

Project Name: Residence Inn River Basin: Little County: Orange Evaluator: FRED KOYAL
 DWQ Project Number: _____ Nearest Named Stream: _____ Latitude: _____ Signature: _____
 Date: _____ USGS QUAD: _____ Longitude: _____ Location/Directions: _____

PLEASE NOTE: If evaluator and landowner agree that the feature is a man-made ditch, then use of this form is not necessary. Also, if in the best professional judgement of the evaluator, the feature is a man-made ditch and not a modified natural stream—this rating system should not be used

Primary Field Indicators: (Circle One Number Per Line)

I. Geomorphology	Absent	Weak	Moderate	Strong
1) Is There A Riffle-Pool Sequence?	0	1	2	3
2) Is The USDA Texture In Streambed Different From Surrounding Terrain?	0	1	2	3
3) Are Natural Levees Present?	0	1	2	3
4) Is The Channel Sinuous?	0	1	2	3
5) Is There An Active (Or Relic) Floodplain Present?	0	1	2	3
6) Is The Channel Braided?	0	1	2	3
7) Are Recent Alluvial Deposits Present?	0	1	2	3
8) Is There A Bankfull Bench Present?	0	1	2	3
9) Is a Continuous Bed & Bank Present?	0	1	2	3
<i>(*NOTE: If Bed & Bank Caused By Ditching And WITHOUT Sinuosity Then Score=0*)</i>				
10) Is a 2 nd Order Or Greater Channel (As Indicated On Topo Map And/Or In Field) Present?	Yes=3		No=0	

PRIMARY GEOMORPHOLOGY INDICATOR POINTS: 3

II. Hydrology	Absent	Weak	Moderate	Strong
1) Is There A Groundwater Flow/Discharge Present?	0	1	2	3

PRIMARY HYDROLOGY INDICATOR POINTS: 1

III. Biology	Absent	Weak	Moderate	Strong
1) Are Fibrous Roots Present In Streambed?	3	2	1	0
2) Are Rooted Plants Present In Streambed?	3	2	1	0
3) Is Periphyton Present?	0	1	2	3
4) Are Bivalves Present?	0	1	2	3

PRIMARY BIOLOGY INDICATOR POINTS: 1

Secondary Field Indicators: (Circle One Number Per Line)

I. Geomorphology	Absent	Weak	Moderate	Strong
1) Is There A Head Cut Present In Channel?	0	.5	1	1.5
2) Is There A Grade Control Point In Channel?	0	.5	1	1.5
3) Does Topography Indicate A Natural Drainage Way?	0	.5	1	1.5

SECONDARY GEOMORPHOLOGY INDICATOR POINTS: 1.5

46

II. Hydrology

	Absent	Weak	Moderate	Strong
1) Is This Year's (Or Last Year's) Leaf litter Present In Streambed?	1.5	1	.5	0
2) Is Sediment On Plants (Or Debris) Present?	0	.5	1	1.5
3) Are Wrack Lines Present?	0	.5	1	1.5
4) Is Water In Channel And >48 Hrs. Since Last Known Rain? (*NOTE: If Ditch Indicated In #9 Above Skip This Step And #5 Below*)	0	.5	1	1.5
5) Is There Water In Channel During Dry Conditions Or In Growing Season)?	0	.5	1	1.5
6) Are Hydric Soils Present In Sides Of Channel (Or In Headcut)?		Yes=1.5		No=0

SECONDARY HYDROLOGY INDICATOR POINTS: 2.5

III. Biology

	Absent	Weak	Moderate	Strong		
1) Are Fish Present?	0	.5	1	1.5		
2) Are Amphibians Present?	0	.5	1	1.5		
3) Are Aquatic Turtles Present?	0	.5	1	1.5		
4) Are Crayfish Present?	0	.5	1	1.5		
5) Are Macrobenthos Present?	0	.5	1	1.5		
6) Are Iron Oxidizing Bacteria/Fungus Present?	0	.5	1	1.5		
7) Is Filamentous Algae Present?	0	.5	1	1.5		
8) Are Wetland Plants In Streambed?	SAV	Mostly OBL	Mostly FACW	Mostly FAC	Mostly FACU	Mostly UPL
(* NOTE: If Total Absence Of All Plants In Streambed As Noted Above Skip This Step UNLESS SAV Present*)	2	1	.75	.5	0	0

SECONDARY BIOLOGY INDICATOR POINTS: 1.0

TOTAL POINTS (Primary + Secondary) = 9 (If Greater Than Or Equal To 19 Points The Stream Is At Least Intermittent)

Notes:

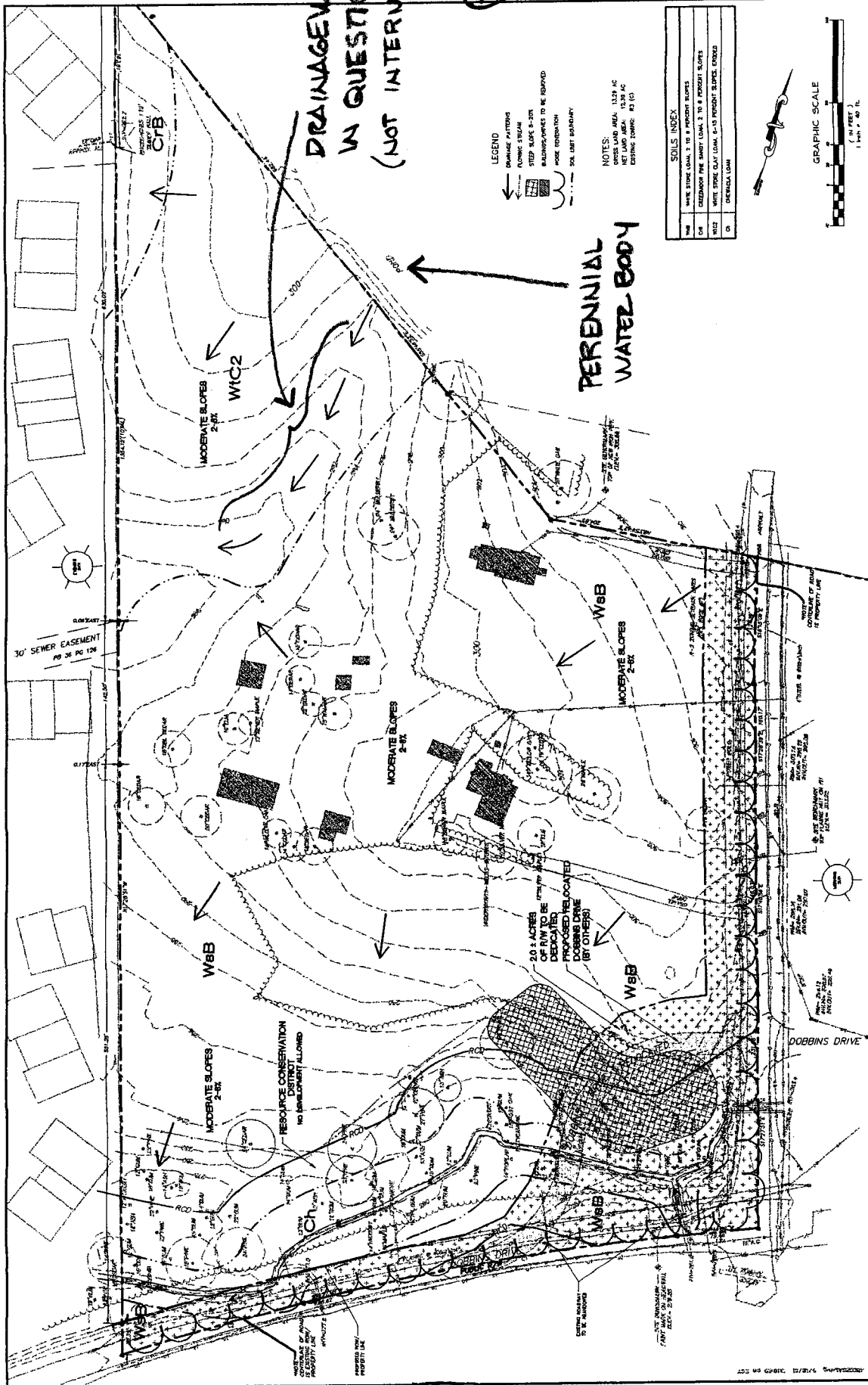

**DRAINAGEWAY
IN QUESTION
(NOT INTERMITTENT)**

(45)

**PERENNIAL
WATER BODY**

- LEGEND**
- DRAINAGE PATTERNS
 - FLOWING STREAM
 - STEP SLOPE 8-10%
 - BUILDINGS/PORCHES TO BE REMOVED
 - POSE IDENTIFICATION
 - SOIL UNIT BOUNDARY

NOTES:

- 1. GROSS LAND AREA: 13.29 AC
- 2. NET LAND AREA: 12.00 AC
- 3. SETBACK: 10 FT
- 4. SETBACK: 10 FT
- 5. SETBACK: 10 FT

SOILS INDEX	
W1	WHITE STONE LOAM, 7 TO 8 PERCENT SLOPES
W2	CHEROKEE FINE SANDY LOAM, 2 TO 8 PERCENT SLOPES
W3	WHITE STONE CLAY LOAM, 6-10 PERCENT SLOPES, EXPOSED
W4	CHEROKEE LOAM

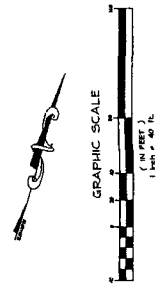

<p>Kimley-Horn and Associates, Inc. P.O. BOX 30098 - RALEIGH, NORTH CAROLINA 27608-3009 PHONE: (919) 877-3000</p>	<p>CLIENT: Summit Hospitality Group LTD</p>	<p>PROJECT: Residence Inn Chapel Hill, NC</p>
	<p>TITLE: SITE ANALYSIS</p>	<p>DATE: 10/14/2002</p>

NO.	REVISION	DATE	BY	CHK.
1	RELEASED FOR TOWN COMMISSIONS / FINAL DESIGN	8/14/02	J.K.	J.K.

Copyright Kimley-Horn and Associates, Inc., 1999

48

RADWAY & WEAVER

Planning & Development Consultants

January 29, 2003

505 Westminster Drive
Chapel Hill, NC 27514

Fred Royal
Engineering Department
Town of Chapel Hill
306 North Columbia Street
Chapel Hill, NC 27516

RE: Residence Inn Mixed-Use Development Proposal
Intermittent Stream Field Survey

Dear Mr. Royal:

On behalf of the applicant, Summit Hospitality Group, Ltd., I hereby request that you examine a topographic swale on the applicant's property to determine if it meets the criteria for an intermittent stream as included in the newly adopted Land Use Management Ordinance. A nearby resident asked whether this swale was or was not an intermittent stream at the Council Public Hearing on this development proposal on January 22, 2003. We believe that the Council and nearby property owners would like to know, as would we, the classification of this swale. If it is not an intermittent stream, would it be classified an ephemeral stream?

The attached request and site information shows the location of the swale and includes the site survey submitted as part of the application.

I understand that you conduct your site visit without the applicant or others so that you may conduct your analysis as promptly as possible.

If you desire additional information please let me know.

Sincerely,



Scott Radway, AICP

cc: Gene Singleton, Summit Hospitality Group, Ltd.

